

ROCKEFELLER

CONFERENCE & VENUE HIRE PACKAGES

Located in the heart of Cape Town's business district, The Rockefeller - has outstanding conference and event facilities. The hands-on professional team and event specialists will assist in curating all your business needs with customized room designs and tailor-made packages and events.

Conference Packages

(Min. 20 guests applicable for the Day
Conference Package rates)

- Half Day DCP R 445 nett pp
& R490 per person commissionable 10%
- Full Day DCP R 495 nett pp
& R545 per person commissionable 10%

Meeting Room Packages

- Hourly fee from R 400 p/h
- Half Day from R 1 250
- Full Day from R 2 500

Coffee & Tea Breaks

(On request, available for the Meeting Rooms
only over and above the hourly/daily charge)

- Half Day from R 65 pp
- Full Day from R 95 pp



MEETING ROOMS & SEATING CAPACITY

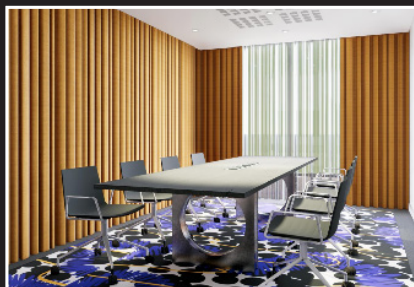

Meeting Room 1

Capacity: 8 pax

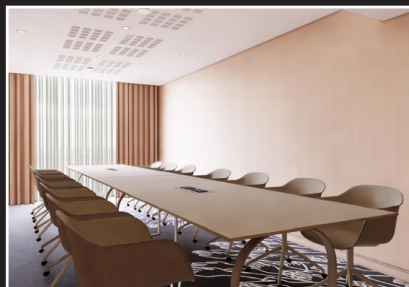

Meeting Room 3

Capacity: 14 pax



Meeting Room 2

Capacity: 8 pax



Meeting Room 4

Capacity: 6 pax

STANDARD VENUE EQUIPMENT/INCLUSIONS

- Notepad
- Flip Charts & Pens
- Whiteboards & Markers
- Microphones
- High-quality Audio-visual Equipment
- Podium
- LED Display Monitors (Meeting Rooms)
- LCD Projectors (Conference Venues)
- Stationary Box

ROCKEFELLER

Meeting Floor

- 2x Conference Rooms (50 – 400 Capacity)
- 4x Boardrooms (6 – 14 Capacity)
- State-of-the-Art Technology
- In-Room Coffee and Tea Facilities (Meeting Rooms Only)
- Refresher Breakaway Spaces
- Floor Dedicated Restrooms
- On-Call Service Ambassadors
- Natural Daylight (Meeting Rooms Only)
- In-Room Catering Available
- Daily Fogging Sanitization Schedule
- Dim-out curtains
- 360 Degrees All in One Conference Camera with microphone
- Wall mounted TVs with casting facilities (Meeting Rooms Only)
- High-speed uncapped Wi-Fi
- Retractable screens (Conference Rooms Only)
- Individual room climate control
- Business services (Fax, Copying, etc.)



CONFERENCE VENUES

Conference Room 1 (CR1)

m² - 140 | Sq feet - 1506 | Ceiling Height - 2,4

Conference Room 2 (CR2)

m² - 61 | Sq feet - 656 | Ceiling Height - 2,1

Conference Venue 1 and 2 can open up into one large meeting room or event space.

SEATING STYLES & CAPACITIES

Conference/ Hollow Square	Theatre	Classroom	Banquet/ Rounds	U/E/T	Reception/ Cocktail
CR1 43 CR2 19	CR1 167 CR2 56	CR1 63 CR2 27	CR1 125 CR2 55	CR1 36 CR2 19	CR1 151 CR2 66

CONFERENCE VENUE HIRE RATES

Hourly fee from R 1 500 p/h	Half Day from R 4 500	Full Day from R 9 500
24 Hour Conference Package - R 1 800 pp Full Day Conference Package Dinner Bed Breakfast (Three-course Meal + Two Soft Drinks / Juice / Water)		

DINING FACILITIES

- All-Day Dining at Empire Restaurant
- Room Service from 07h00 - 23h00
- 24/7 Grab & Go Deli
- MISO Sushi Bar
- Social Lounge
- In-House Mixologist
- Barista Handcrafted Coffee

Parking not included and standard on street parking options available.